

Spring Creek P L A Z A



JOS. A. BANK

JOS. A. BANK CLOTHIERS

JOS. A. BANK CLOTHIERS

CHICO'S

FUZZY'S
TACO SHOP

TABLE OF CONTENTS

PG. **3** ABOUT

PG. **4** TRADE AERIAL

PG. **5** SITE AERIAL

PG. **6** SITE PLAN

PG. **7** CONCEPTUAL EXPANSION
PLANS

PG. **8-9** PHOTOS

ABOUT

PROJECT SCOPE

Located in the heart of Oklahoma, just north of Oklahoma City, Edmond offers outstanding hotels, conveniently located attractions, championship golf, and nostalgic shopping areas featuring the unique and antique, all with the added pleasure of beautiful public art on almost every corner. Edmond is also home to the oldest university in Oklahoma, the University of Central Oklahoma, and third largest school district in the state (#1 ranked school district in Oklahoma - Niche.com, 2019).

DEMOGRAPHICS

	1 mile	2 mile	5 mile
Est. Population	10,032	68,262	129,400
Avg. HH Income	\$111,410	\$112,116	\$128,910
Total Housing Units	4,095	27,456	49,491
Daytime Population	10,364	70,819	124,551
Medium Home Value	\$242,555	\$243,333	\$271,933

DETAILS

- 63,000 SF in Phase 1 up to 30,000 SF of potential retail space in Phase 2
- Complementary mix of popular national retailers and local businesses
- Voted best Shopping Center in Edmond, 4 years in a row

TRAFFIC COUNTS

- E 15th St: 16,721 VPD-25
- S Bryant Ave: 22,804 VPD-25

AREA ATTRACTIONS



2nd & Bryant
Shopping Center



Memorial High School
Edmond Santa Fe High School

SITE AERIAL



SITE PLAN | PHASE 1

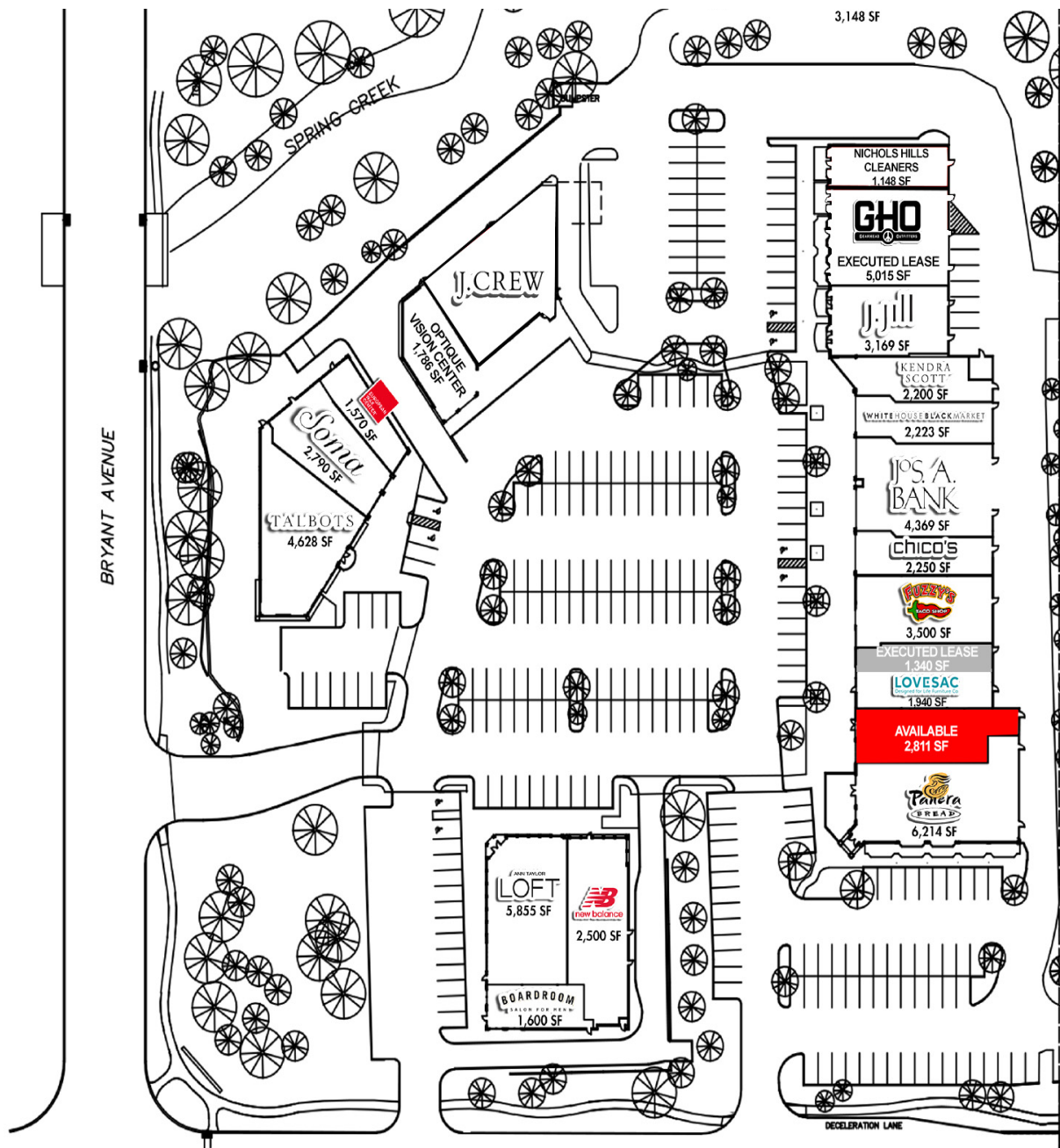

CONCEPTUAL EXPANSION SITE PLAN | PHASE 2

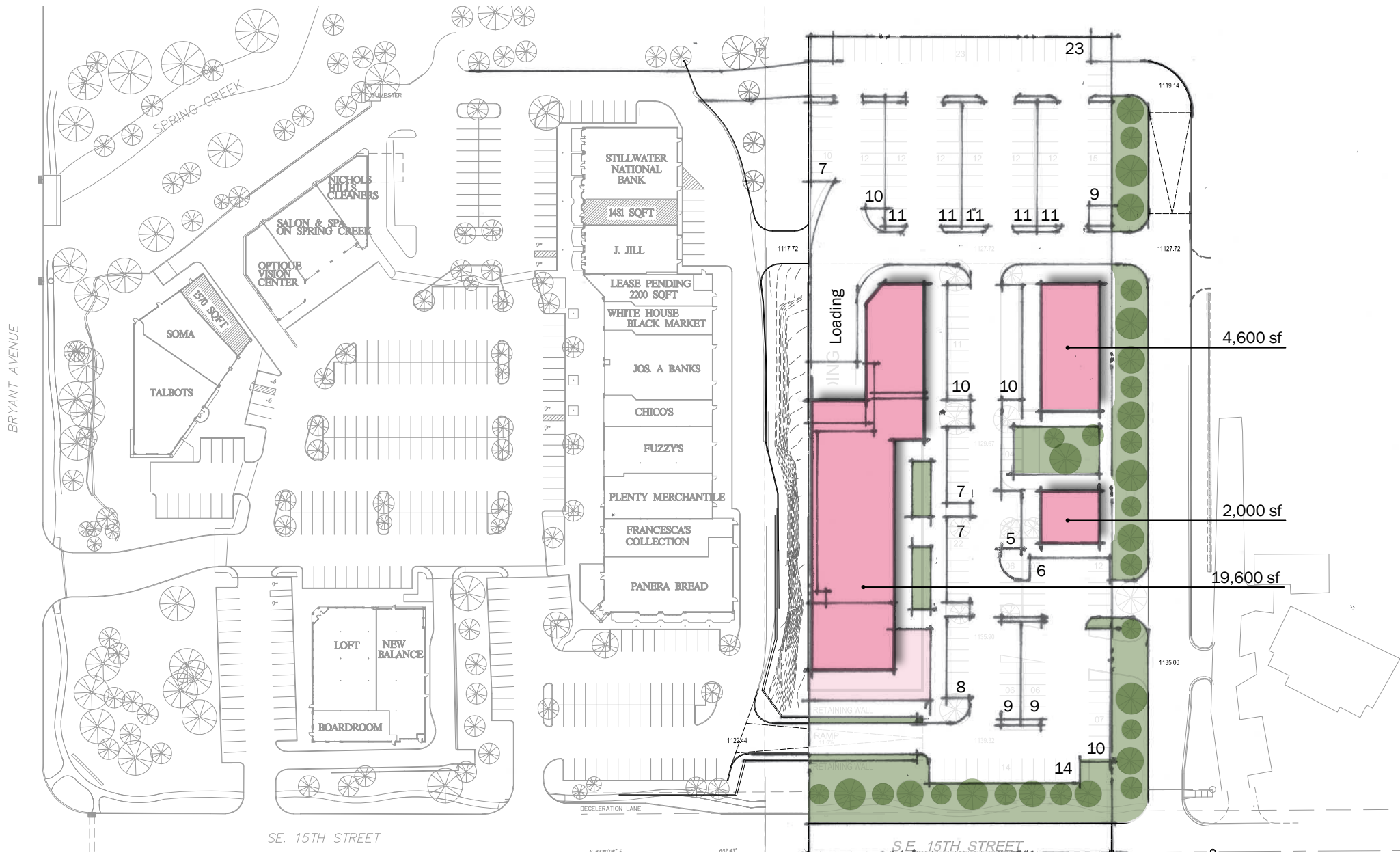

PHOTOS



PHOTOS



SHOP^{CO.}

Kendra Roberts

KENDRA@SHOPCOMPANIES.COM

214-632-3933

Jacob Logsdon

JACOB@SHOPCOMPANIES.COM

405-919-7951